

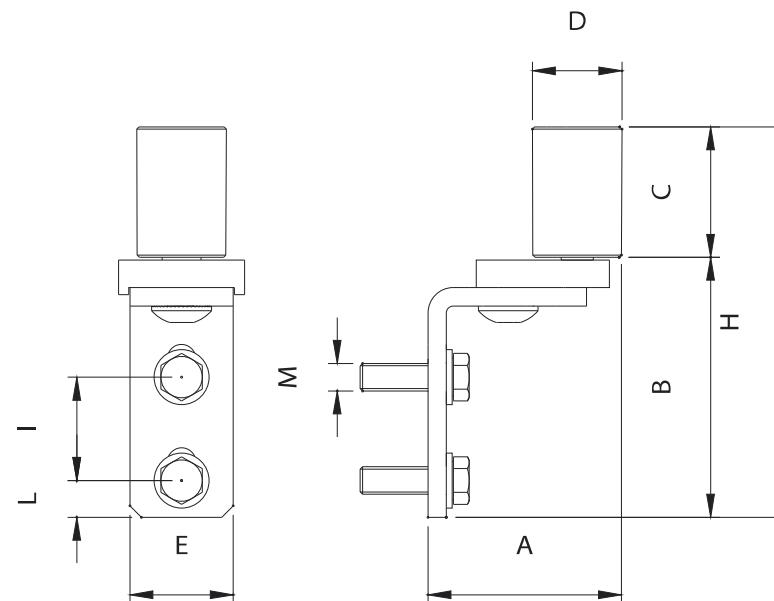

# Art. CG-252

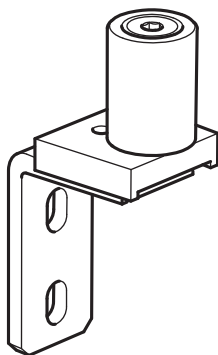

TECHNICAL CHARACTERISTICS				
		CG-252		
WEIGHT OF PART		0,80 Kg		
ASSOCIATED CHANNEL		CG-254		
MAINTENANCE FREQUENCY				
PRIVATE HOME	COMPANY	WAREHOUSE	CONDOMINIUM <20 UNITS	CONDOMINIUM > 20 UNITS
2 YEARS*	2 YEARS*	2 YEARS*	1 YEAR*	1 YEAR*
Check roller.				
Check fixing.				
*The scheme refers to a normal workplace (not marine or particularly aggressive environments).				

Art.	Code	A	B	C	D	E	H	I	L	M		
CG-252	11310100 001	55-85	109	57	Ø40	46	167	53	16	M12	2	1,60

